

# Habitaflex Open plan

E3 Series

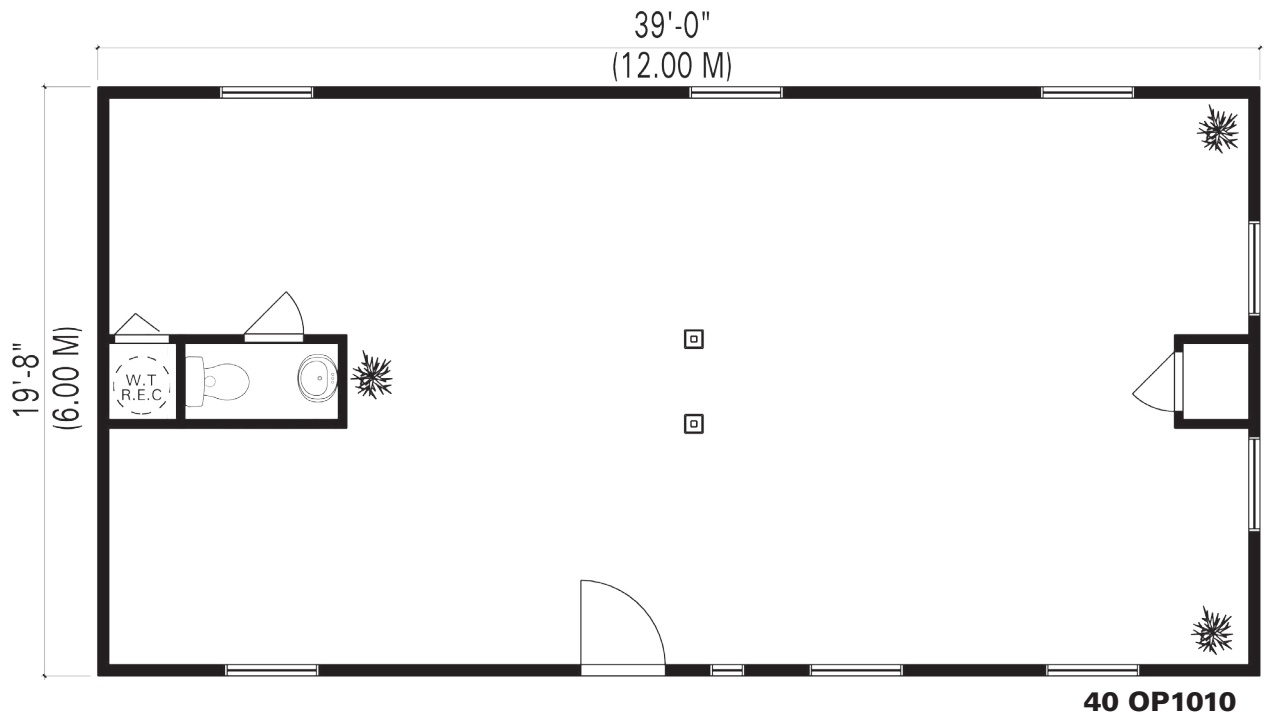

habitaflex.com  
**HABITAFLEX**<sup>®</sup>  
QUICK BUILDING SOLUTIONS

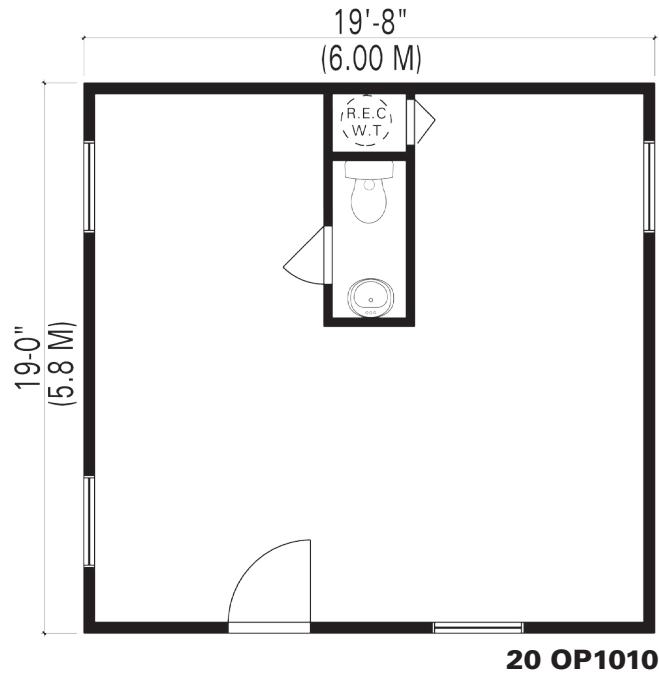

# Habitaflex Open plan

## E3 Series

### Open plan (20 OP1010, 40 OP1010)

#### Structure:

- Built with structural insulated panels
- Expanded polystyrene insulation without CFCs
- Rustic grooved board finish on exterior walls (Choice of colors)
- Oven dried wood carpentry
- Pre-painted galvanized steel roofing
- White PVC sliding windows
- Insulated steel door

#### Interior Finish:

- Floor : Dyed and varnished Oriented Strand board (OSB), with 24" x 24" (609x609mm) grooved tiles
- Natural grooved Oriented Strand board (OSB)

#### Electricity:

- Independent electrical heat system in every room
- 1 Cable/Phone jack outlet per room

#### Plumbing:

- Toilet & sink
- Quick connect water inlet
- 1/2" (12.7 mm) Pex water lines & ABS drainage piping

#### Options Available:

- «Quick Connect» Electric system
- 220V Electricity
- «Far North» Insulation
- Double or triple paned windows with argon
- Soundproof partitions
- Solid doors with acoustic door seal
- Borate treatment of the structure
- Panoramic windows
- Natural pine board interior finish
- Gypsum Wallboard interior finish (plastering must be completed on site)



Distributor